

COLLECTING GAS BY WATER DISPLACEMENT

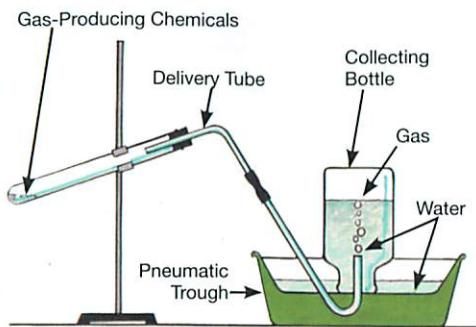

USING A BURET

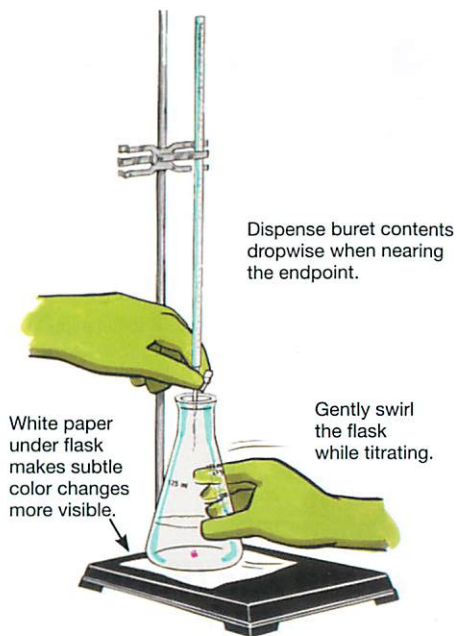

SETTING UP A VACUUM FILTRATION

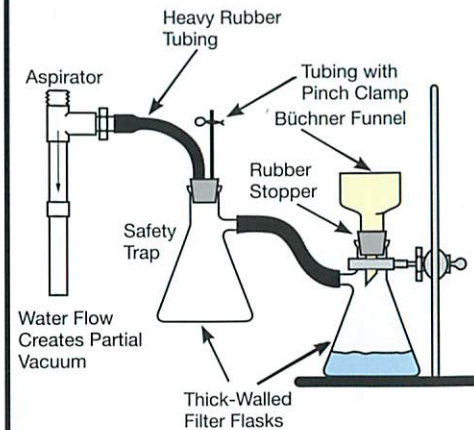

A safety trap is recommended to prevent water from backing up into filter flask. Both the filter flask and safety trap should be clamped to ring stands.

USING A HOT WATER BATH

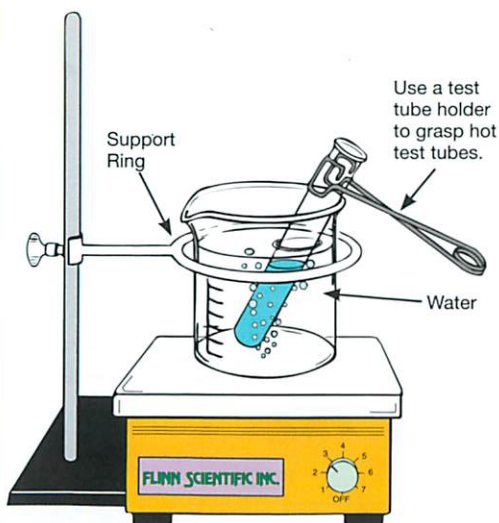

DISTILLING LIQUIDS

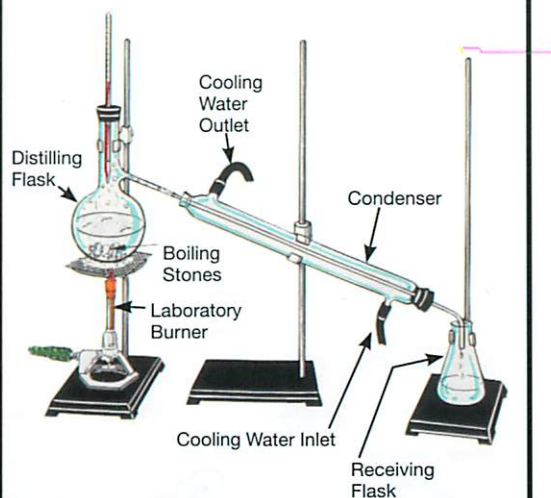

Do not distill to dryness.
Use extreme caution when distilling mixtures containing flammable liquids.

CLEANING GLASSWARE

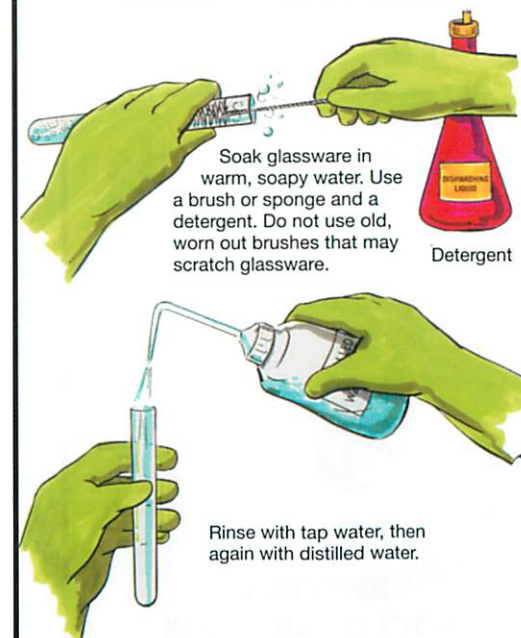

LABORATORY EQUIPMENT

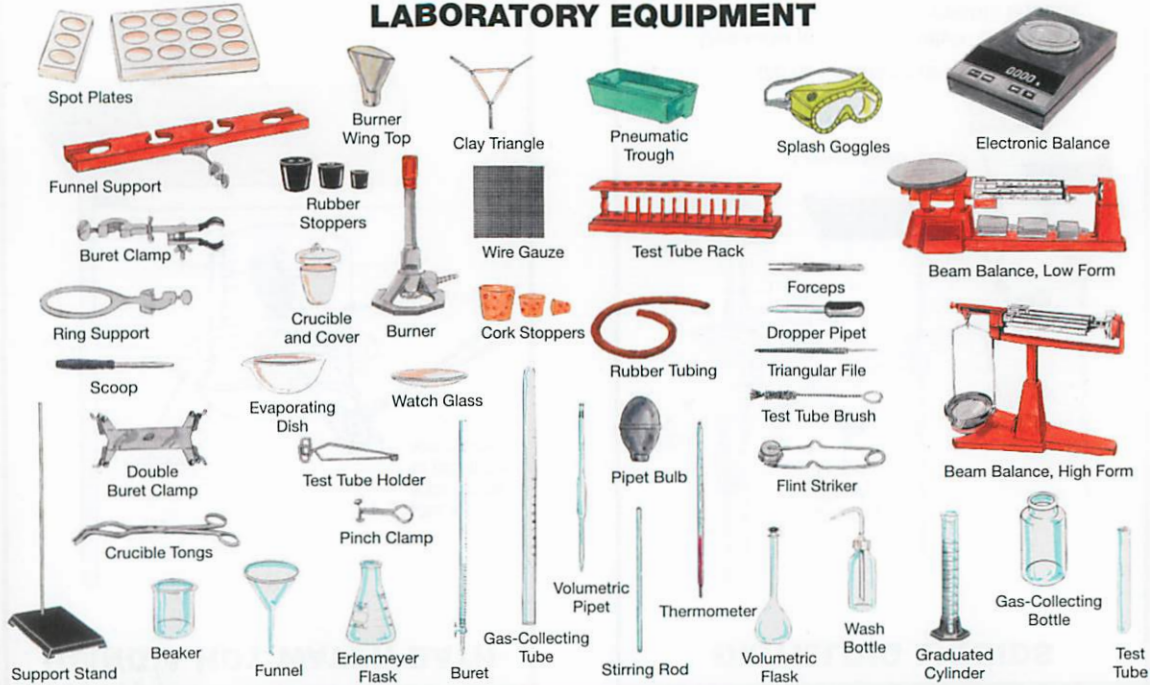

MEASURING LIQUID VOLUMES

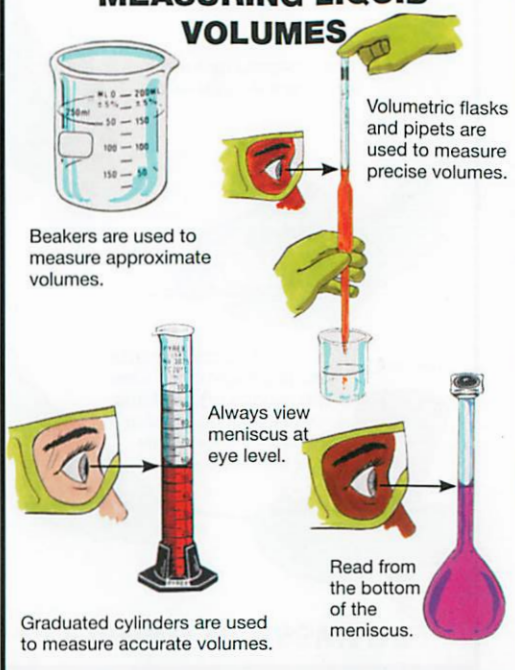

TRANSFERRING LIQUIDS

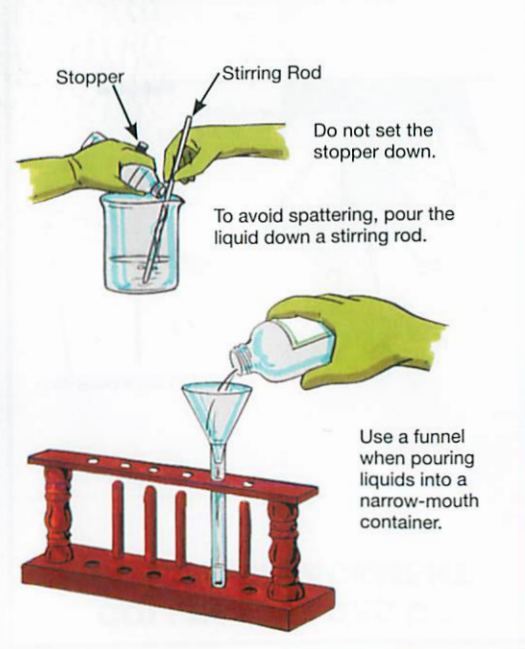

LIGHTING A LABORATORY BURNER

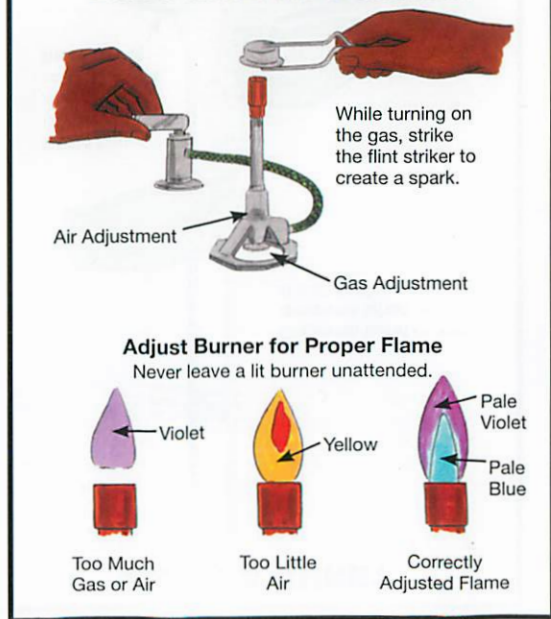

HEATING A LIQUID

